

12"- 140W Ceramic Guitar Loudspeaker

C 12/70 EL - 8 Ω

Code ZJ06380

GENERAL CHARACTERISTICS		
Nominal Overall Diameter	307	mm
Nominal Voice Coil Diameter	50	mm
Magnet Weight	1450	g
Flux Density.....	1.15	T
Weight.....	4.50	Kg

THIELE-SMALL PARAMETERS			
Voice Coil DC Resistance	R_E	6.33	Ω
Resonance Frequency	f_s	95.0	Hz
Mechanical Q Factor.....	Q_{MS}	14.77	
Electrical Q Factor.....	Q_{ES}	0.70	
Total Q Factor	Q_{TS}	0.67	
Mechanical Moving Mass	M_{MS}	29.9	g
Mechanical Compliance.....	C_{MS}	94	μm/N
Force Factor	$B \times l$	12.70	Wb/m
Equivalent Acoustic Volume.....	V_{AS}	32.0	lt.
Maximum Linear Displacement	X_{MAX}	+/-1.0	mm
Reference Efficiency	η_0	3.76	%
Diaphragm Area	S_D	490.9	cm ²
Losses Electrical Resistance.....	R_{ES}	133.3	Ω
Voice Coil Inductance @ 1kHz	L_E	0.60	mH

CONSTRUCTIVE CHARACTERISTICS	
Magnet.....	Ferrite
Voice Coil Winding.....	Aluminium
Voice Coil Former	Kapton
Cone	Paper
Surround.....	Paper - Integrated
Dust Dome	Non Treated Cloth
Basket	Pressed Sheet Steel

ELECTRICAL CHARACTERISTICS		
Nominal Impedance.....	8	Ω
Musical Power	140	W
Rated Power*	70	W
Sensitivity @ 1 W, 1 m	99.0	dB

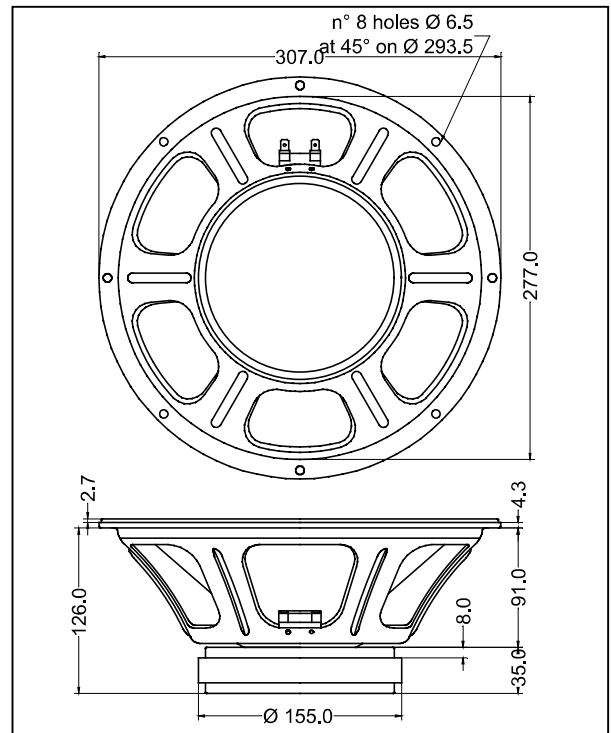

*rated power measured with 2 hours test with pink noise signal, 6 dB crest factor, loudspeaker mounted on enclosure
 Thiele-Small parameters measured with IASFR system

Frequency Response on IEC Baffle (DIN 45575) @ 1 W, 1 m - Impedance

