

FOOT SWITCH

SPECIFICATIONS

Rating	AC125V 6A AC250V 3A DC30V 4A
Contact Resistance	50 mΩ Max. Silver contacts
Insulation Resistance	DC500V-100 MΩ Min.
Withstand Voltage	AC1000V-1 Minute
Operating Force	1.6±0.5 Kgf
Life Cycles	10,000 Cycles
Sizes (m.m)	As Following Drawing

文管中心
2012.05.23
發行章

石排福隆工業區工業電子廠
2012-06-11
收文日

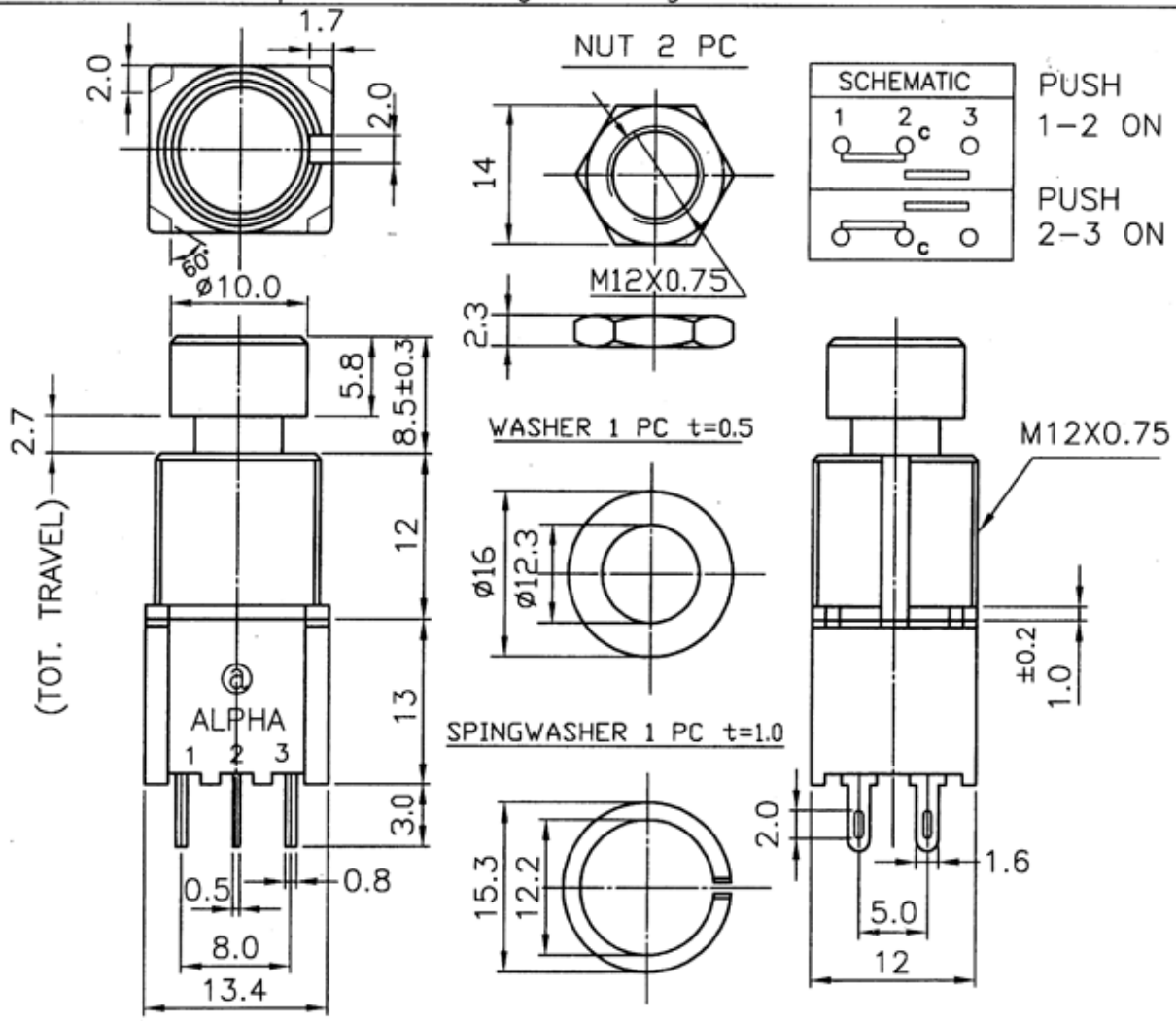

NOTE: 1. TOLERANCES UNLESS OTHERWISE SPECIFIED: ±0.3mm
2. FUNCTION: LATCHING

Date	2012.5.23	DWN	黃 2012.5.23 傑	CHKD	APP'D	呂 101.5.23 芳誠
------	-----------	-----	---------------------	------	-------	---------------------