

Ausgangsübertrager | Outputtransformer - TT-DMB100-OT

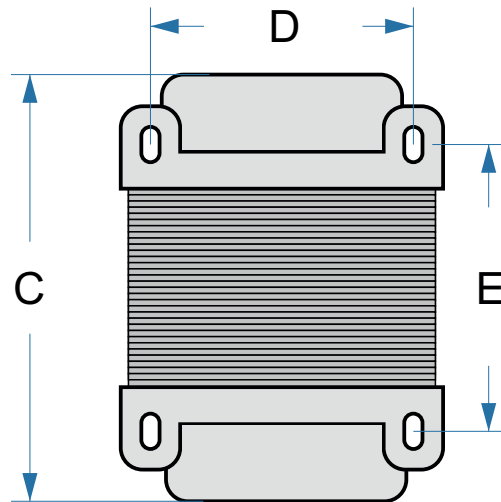
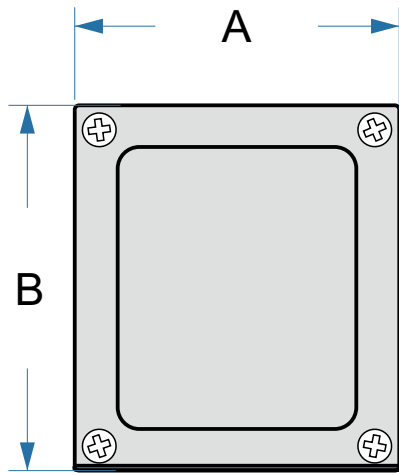

Größe | Dimension [mm]

A: 95
B: 110
C: 110
D: 80
E: 62

+/- 1 mm

Primär | Primary

Sekundär | Secondary

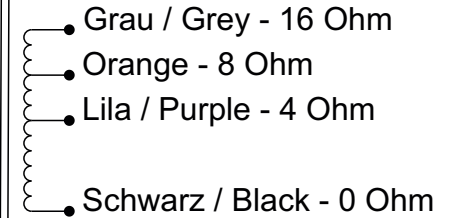
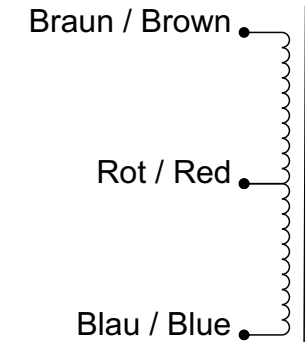

Zeichnung nicht maßstabsgetreu
Drawing not to scale

Spezifikation | Specification

Pri: 2,2 kOhm - Push/Pull

Sec: 4-8-16 Ohm

P: 100 W (27Hz -3dB)

EN61558

