

# Netztransformator | Powertransformer - TT-MAJ50-PW

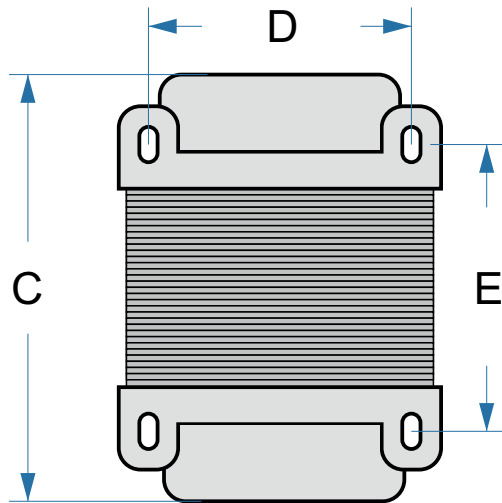
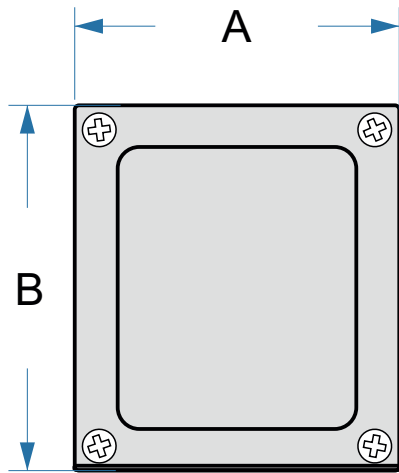

## Größe | Dimension [mm]

A: 96  
B: 115  
C: 110  
D: 80  
E: 62

+/- 1 mm

## Primär | Primary

240 V - Weiß / White

230 V - Blau / Blue

120 V - Pink

0 V - Braun / Brown

## Sekundär | Secondary

345 V - Lila / Purple

Grau / Grey

345 V - Lila / Purple

3,15 V - Grün / Green

Schwarz / Black

3,15 V - Grün / Green

5 V - Orange

0 V - Orange

12,6 V - Rot / Red

0 V - Rot / Red

Zeichnung nicht maßstabsgetreu  
Drawing not to scale

## Spezifikation | Specification

Pri: 0-120-230-240 V @ 50Hz

Sec1: 345-0-345 V @ 175 mA

Sec2: 3.15-0-3.15 @ 5 A

Sec3: 0-12.6V @ 1 A

Sec4: 0-5V @ 3 A

EN61558

