

Chassis-Masse erfassen
Determine Chassis Dimensions

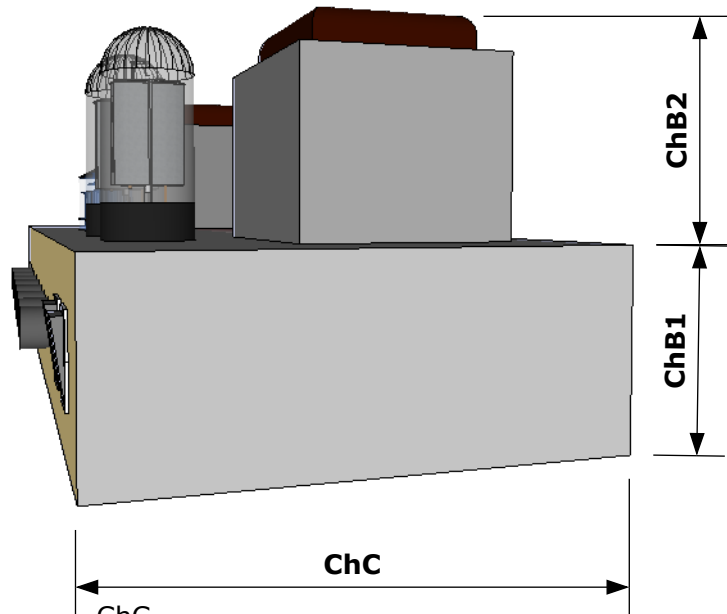

ChC
 incl. Front und Rückblende
 incl. Front and Rear Panel

Chassis Grösse / Size

ChA:	mm
ChB1:	mm
ChB2:	mm
ChB:	mm
ChC:	mm

$ChB = ChB1 + ChB2$

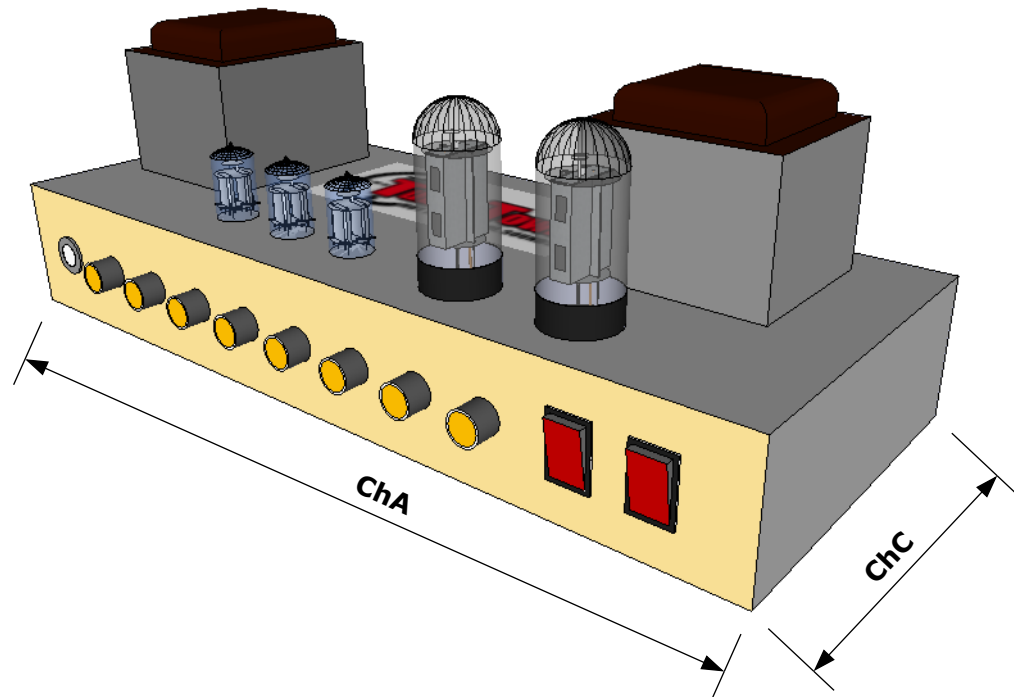
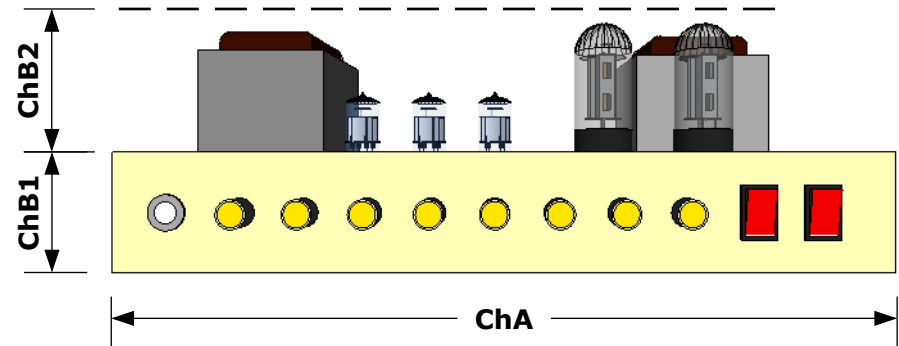



TTC Customshop Combo
 British CO25

Gehäuse Berechnung
Enclosure Calculation

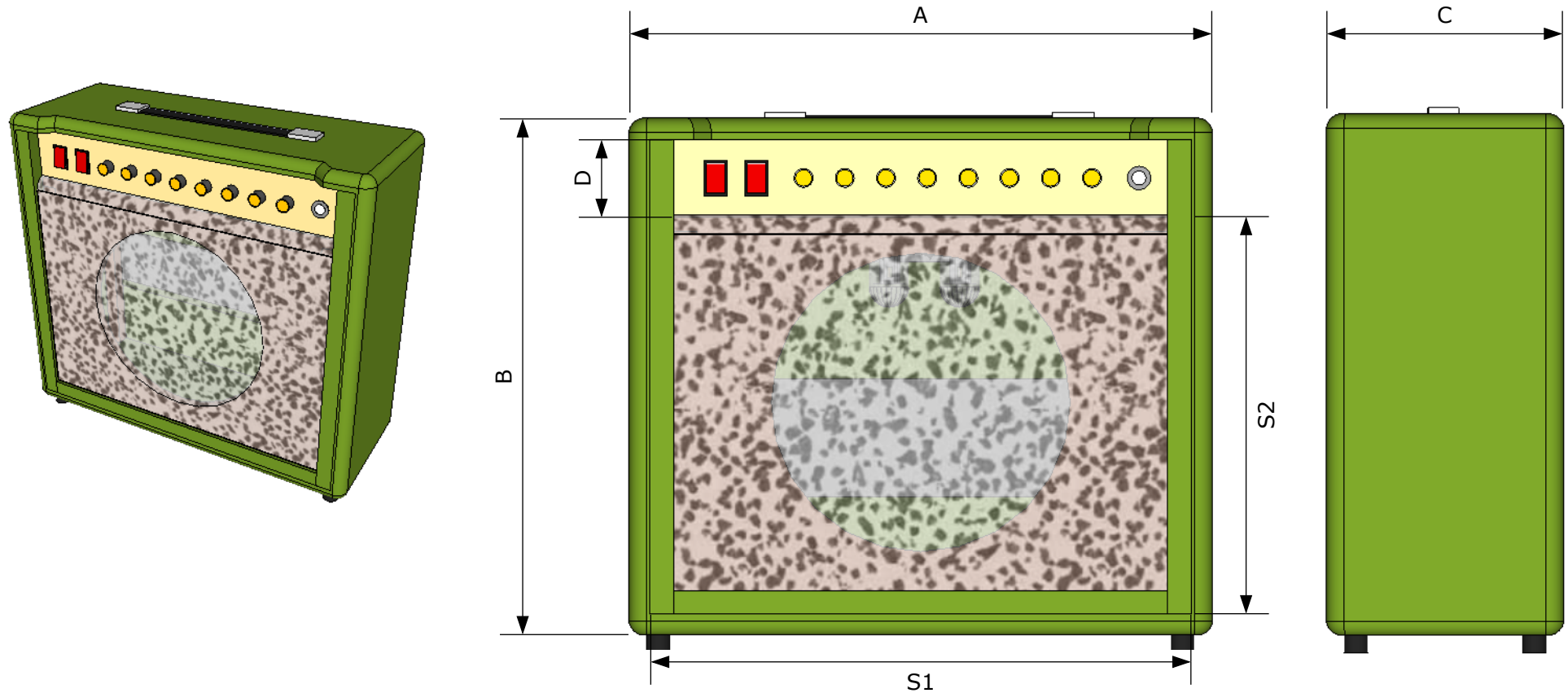

Material:

Korpus / Body: 15 mm Birke Multiplex / 15 mm Birch Plywood
Schallwand / Baffle: 12 mm Birke Multiplex / 12 mm Birch Plywood
Rückblende / Backpanels: 15 mm Birke Multiplex / 15 mm Birch Plywood



TTC Customshop Combo
British CO25

Gehäuse Berechnung
Enclosure Calculation

Berechnung / Calculation

A = ChA + 50 mm:		mm
B =		mm
C = ChC + 33 mm:		mm
D = ChB1 -3 mm:		mm
E =		mm
F =		mm
G = A - 74 mm		mm
S1 = ChA + 40 mm		mm
S2 = B - D - 50 mm		mm

S2 Min. Grösse / Min. Size

- 8" = 260 mm
- 10" = 315 mm
- 12" = 360 mm
- 15" = 435 mm

S1 Min. Grösse / Min. Size

- 8" = 260 mm
- 10" = 315 mm
- 12" = 360 mm
- 15" = 435 mm

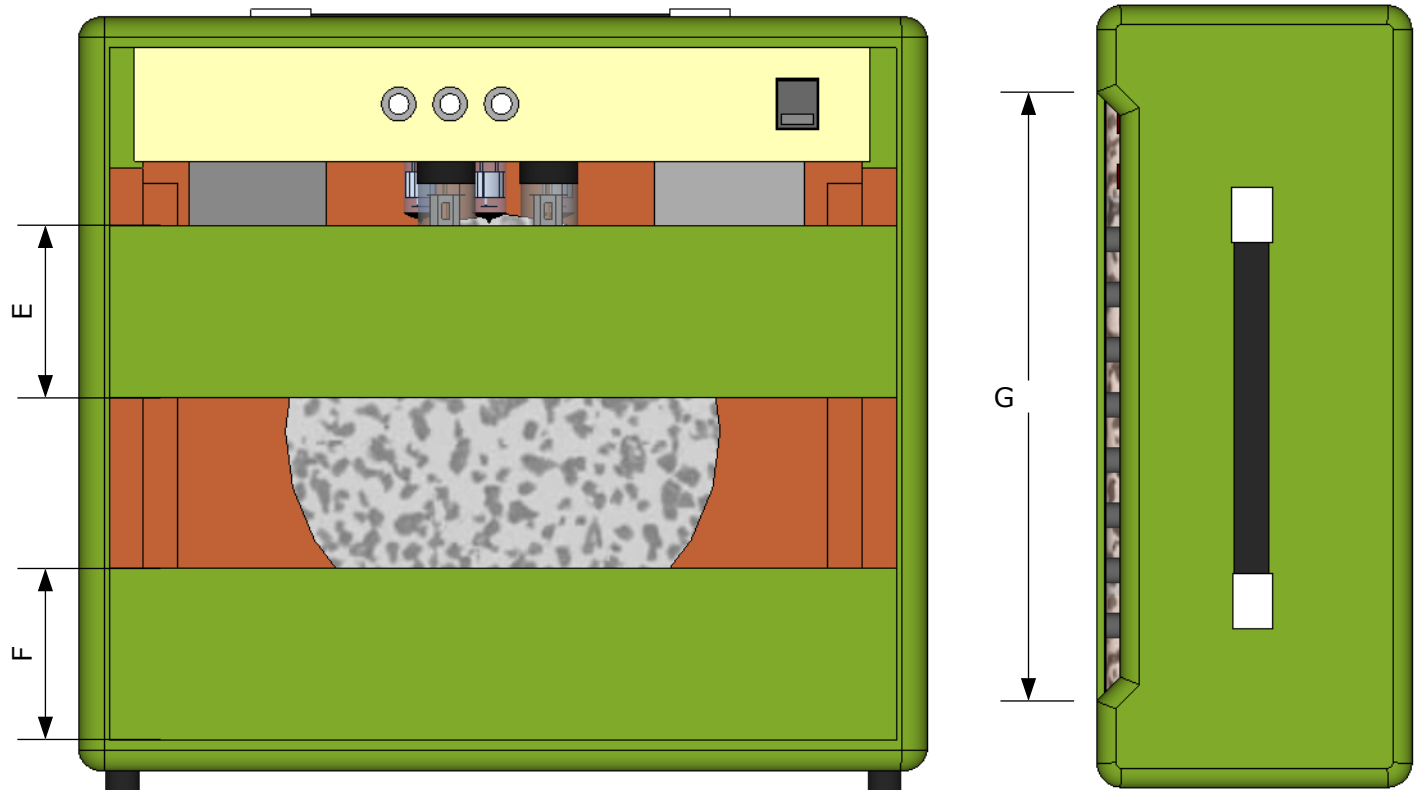

All illustrations are not to scale !
 Please see product-descriptions for details and features.
 Due to continual improvement, all specifications are subject to change without notice.

Alle Darstellungen sind nicht massstabgetreu !
 Weitere Details und Ausstattungsmerkmale sind der Produktbeschreibung zu entnehmen.
 Durch permanente Weiterentwicklung können Änderungen ohne Vorankündigung durchgeführt werden.



TTC Customshop Combo
 British CO25

Gehäuse Berechnung
Enclosure Calculation

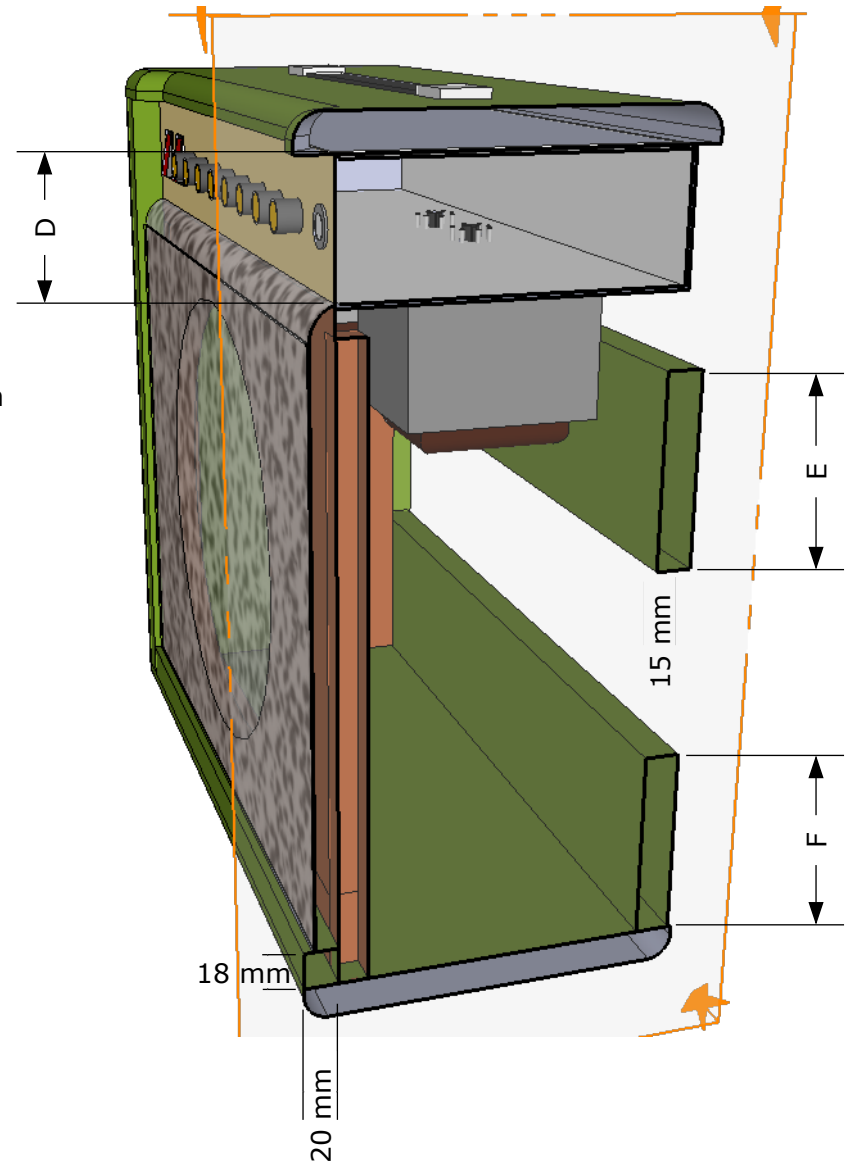
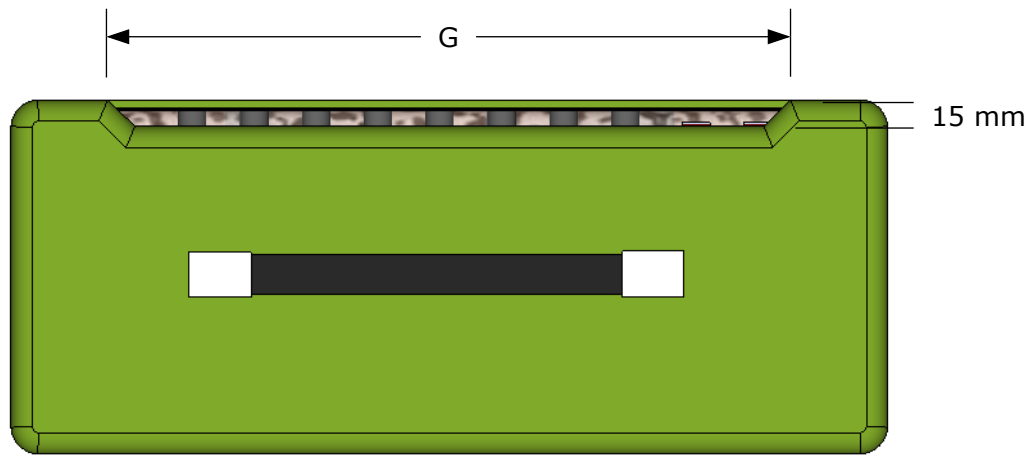

TTC Customshop Combo
British CO25